

<b>Type Number</b> .....	6012
<b>Designation IEC</b> .....	
<b>System</b> .....	Li-Manganese dioxide/ Organic Electrolyte
<b>Nominal Voltage</b> .....	3 V
<b>Typical Capacity C</b> .....	60 mAh
<b>Temperature Ranges</b>	min                      max.
Storage .....	-30°C                      60°C
Discharge.....	-10°C                      60°C

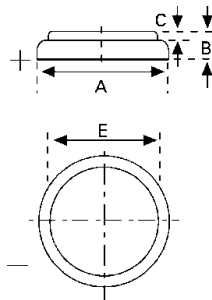

<b>Dimensions</b>	min	max
Diameter (A).....	19,70	20,0
Height (B).....	1,00	1,2
Shoulder Diameter (E).....	17,00	
<b>Weight (approx.)</b> .....	1,4 g	

**Typical Capacities (at 20°C)**

<b>Discharge Type</b>	<b>Load</b>	<b>End Voltage</b>	<b>2.0 V</b>
Continuous 24h/d, 7d/w	15000 Ω	Time [h]	330

**No publication or circulation of data to third parties without consent of VARTA Consumer Batteries**

All Data contained herein is for single cells.  
For battery applications, performance data may vary from single cell data, depending on specific battery configuration.