

Data Sheet

V11A / 4211

- Description** : Alkaline High Voltage Battery
- Nominal Voltage** : 6Volts
- Nominal Dimensions** : Ø10.22mm×16.5mm
- Terminal** : Nickel plated flat contacts - protruded
red(+); recessed black (-)
- Jacket** : Metal jacket
- Internal Connection** : Pressure
- Applications** : Remote controller
- Average Weight** : 4.0g
- Date Code** : Unless otherwise specified, each batteries will carry a numeric year code and analogue month code
- Shelf Life** : Not less than 90% of the service capacity within first year. , not less than 85% of the service capacity with third year storage at $22 \pm 3 \text{ }^\circ\text{C}$
40-80 %RH
- Insulation** : 5MΩ min.
- Resistance**
- Close Circuit Voltage** : 4.7 Volts (min.)(load resistor 200Ω
at $22 \pm 3 \text{ }^\circ\text{C}$ for 0.1 to 2 seconds)
- Current Drain** : Under 15mA pulse, 0.5mA
continuous
- Nominal Service Life** : 74hrs (at 10kΩ load)
(to 3.0V at $22 \pm 3 \text{ }^\circ\text{C}$)
- Average Service Capacity** : 38mAh(at 10kΩ load)
(to 3.0V at $22 \pm 3 \text{ }^\circ\text{C}$)

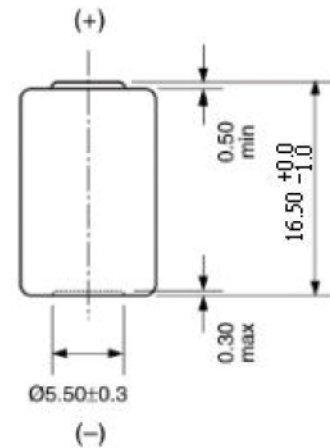
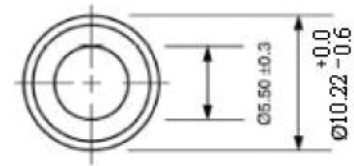

Unit : mm

Typical Discharge characteristics at $22 \pm 3 \text{ }^\circ\text{C}$

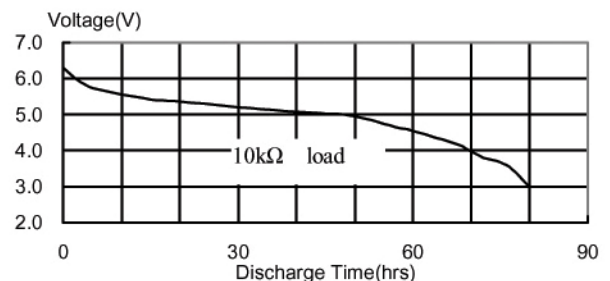

No publication or circulation of data to third parties without consent of VARTA Consumer Batteries