

Data Sheet

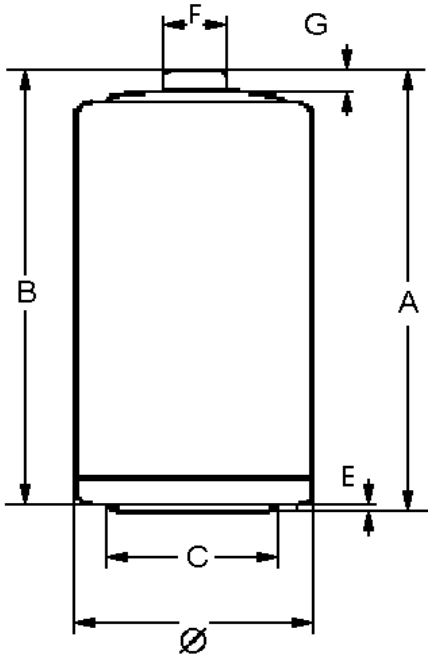

Type Designation	4020
Designation IEC	LR20
System	Zn-MnO ₂ (Alkaline)
Shelf Life (Coding)*	10 years
Nominal Voltage [V]	1.5
Typical Capacity C [mAh]	17000 (discharge with high-resistance)
Permissible Temperature Range	- 20 °C ... 60 °C
Weight, approx. [g]	140,4
Volume [ccm]	51.3

Dimensions [mm]	min:	max:
∅	32.3	34.2
A	-	61.5
B	59.5	-
C	18.0	-
E	-	1.0
F	-	9.5
G	1.5	-



Typical Capacities (at 20°C)

4M/15M,8H/D,7D/W	2.2 Ω	Time [h]	27,1
Portable lighting		Capacity [Ah]	14,1
		Energy [Wh]	16,3
Discharge Type	Load	End Voltage[V]	0.8
1H/D,7D/W	2.2 Ω	Time [h]	29,7
Toy		Capacity [Ah]	14,7
		Energy [Wh]	16,2
Discharge Type	Load	End Voltage[V]	0.9
2H/D,7D/W	600 mA	Time [h]	18,8
Portable Stereo		Capacity [Ah]	11,3
		Energy [Wh]	12,5

* In consideration of typical loss of capacity at storage and application.

Information and contents in this data sheet are for reference purpose only.
They do not constitute any warranty or representation and are subject to change without notice.
For most current information and further details, please contact your VARTA representative.